

Technical Manual

JBL4425 L,R STUDIO MONITOR SPECIFICATIONS



ACOUSTIC & ELECTRICAL SPECIFICATIONS:

- Nominal Impedance: 8 ohm
- Power Rating: 200W, Pink Noise
- Frequency Response: 45 Hz to 16 kHz (± 3 dB)
- Sensitivity: 90 dB SPL*
- Crossover Frequencies: 1.2 kHz

SYSTEM COMPONENTS:

- Cabinet: C4425
- Grille: G4425 (65917)
- Low Frequency Transducer: 300mm (12 in.) Cone Transducer (2214H)
- DC Resistance: 5.7 ohm $\pm 10\%$ — Copper Wire

*1 Watt (2.83 V RMS) @ 1 Meter

SYSTEM COMPONENTS: (cont'd)

- High Frequency Transducer: 25mm (1 in.) Pure Titanium Compression Driver (2416H-1)
- DC Resistance: 3.2 ohm $\pm 8\%$ — Aluminum Wire
- Crossover Network: N3124, 2 Way System (65934-0060)

AURAL SWEEP TEST SPECIFICATIONS:

- A. System Aural Sweep Test: 7.0V Input, 20 Hz to 20 kHz
- B. L.F. Aural Sweep Test: 7.0V Input, 20 Hz to 1.2 kHz
- C. H.F. Aural Sweep Test: 2.83V Input, 550 Hz to 1.2 kHz

PHYSICAL SPECIFICATIONS:

- Enclosure Dimensions: 406mm x 635mm x 311mm D (16.0 x 25.0 x 12.25 in. D)
- Shipping Weight: 65 lbs. (29.5 kg)

WARRANTY INFORMATION:

- Refer to the Warranty Statement packed with each product.

PACKAGE

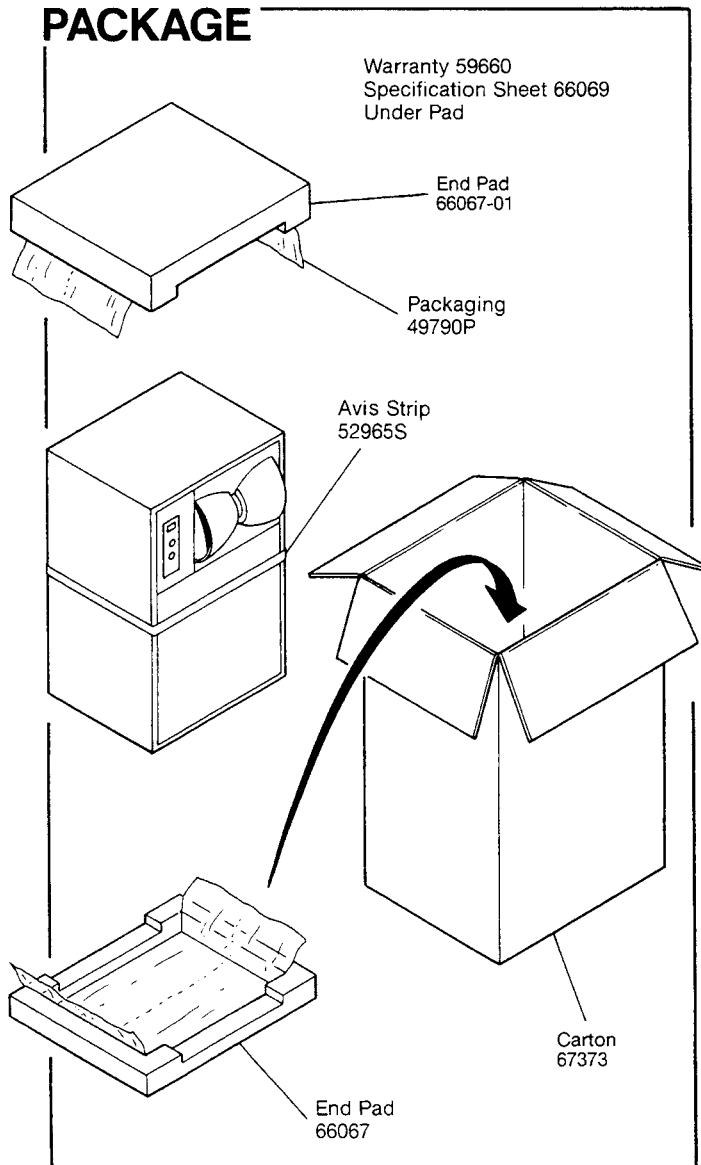

WIRING DIAGRAM

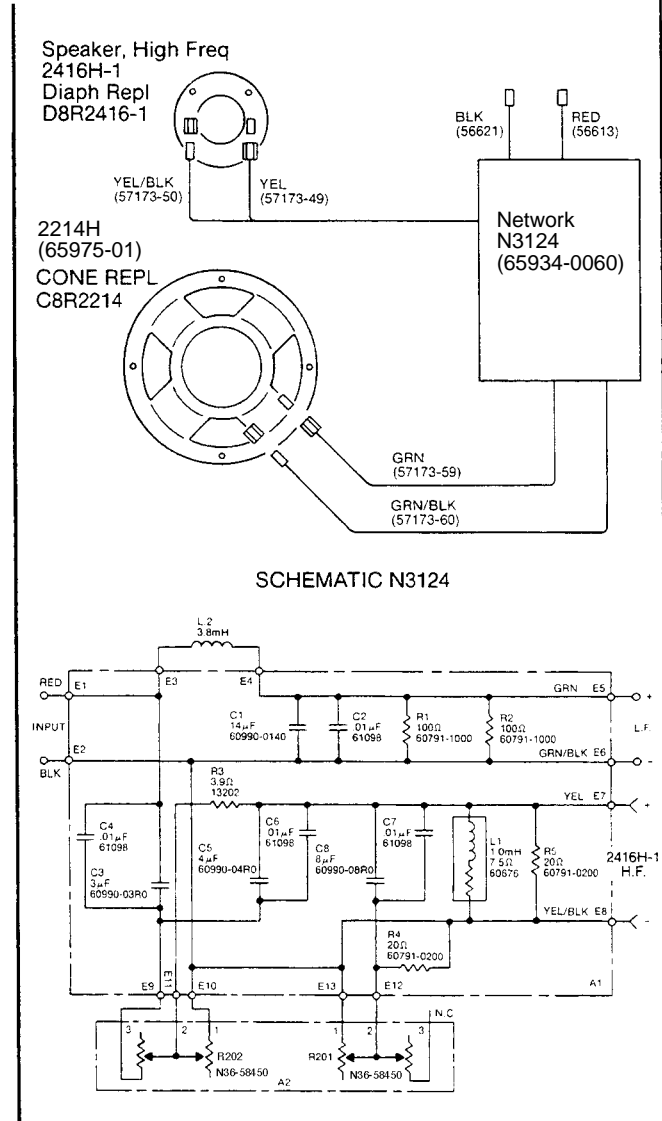

JBL4425 L,R REV F

JBL4425 L,R

COMPONENT EXPLODED VIEW

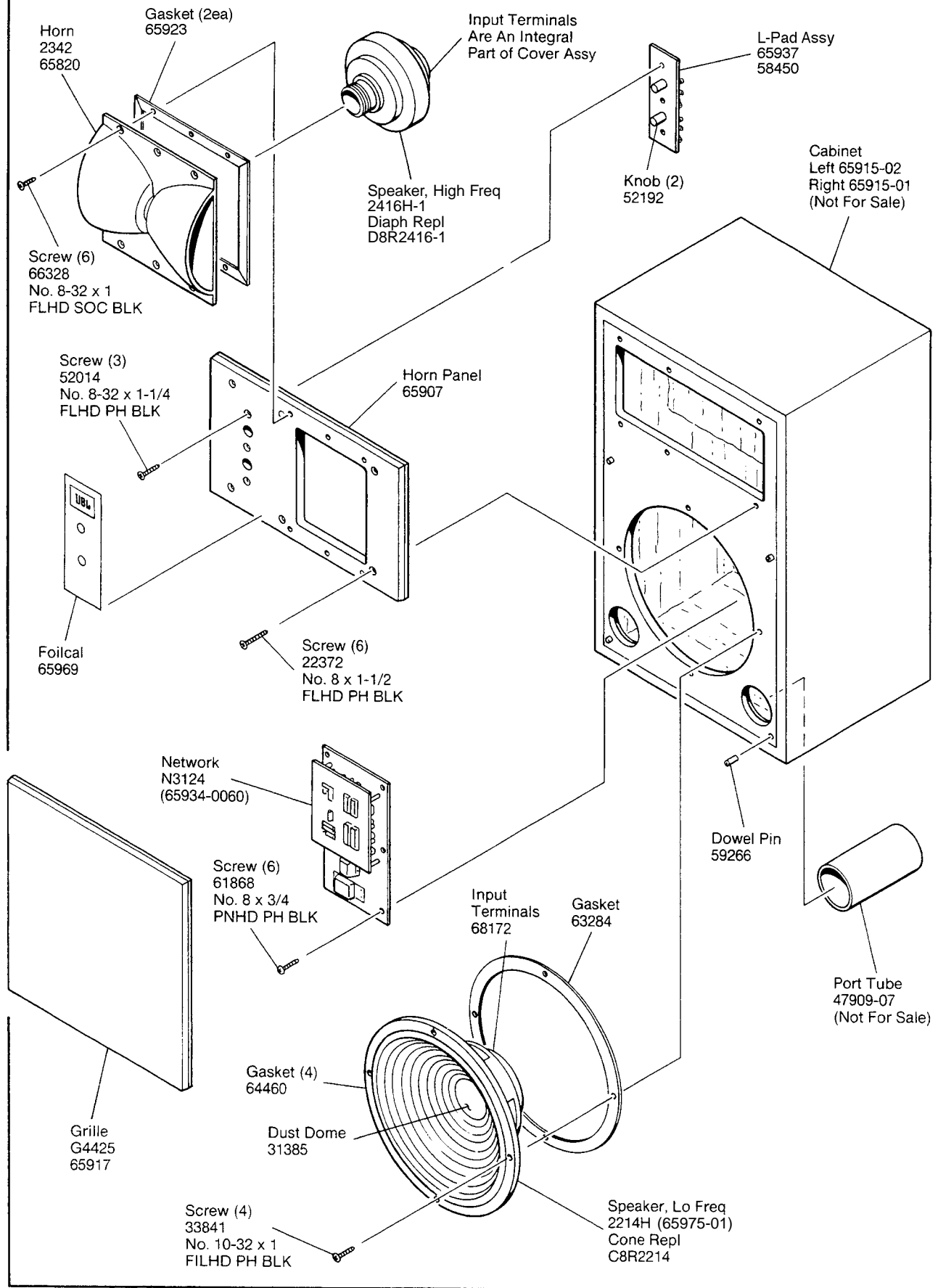

JBL4425 L,R